



Fairmead Crescent

£625,000

Situated in a sought after location within close proximity to Edgware High Street and the underground station is this extended, stunning 5 bedroom 2 bathroom semi-detached property.

On the ground floor the property boasts a bright entrance hallway, 2 spacious receptions room, modern fully equipped kitchen diner with direct access onto south west facing garden with benefit of an annex to the rear. The first floor boasts 3 bedrooms and a family bathroom and separate w/c, with 2 further bedrooms and an additional bathroom on the second floor.

Further benefits include, off-street parking for 3 cars, close to local amenities and transport links and within catchment of local schools. Viewing Highly Recommended. Sole Agent.

Viewing

Please contact our Mill Hill Office on 020 8959 0011 if you wish to arrange a viewing appointment for this property or require further information.



5



2



2



Floor Plan

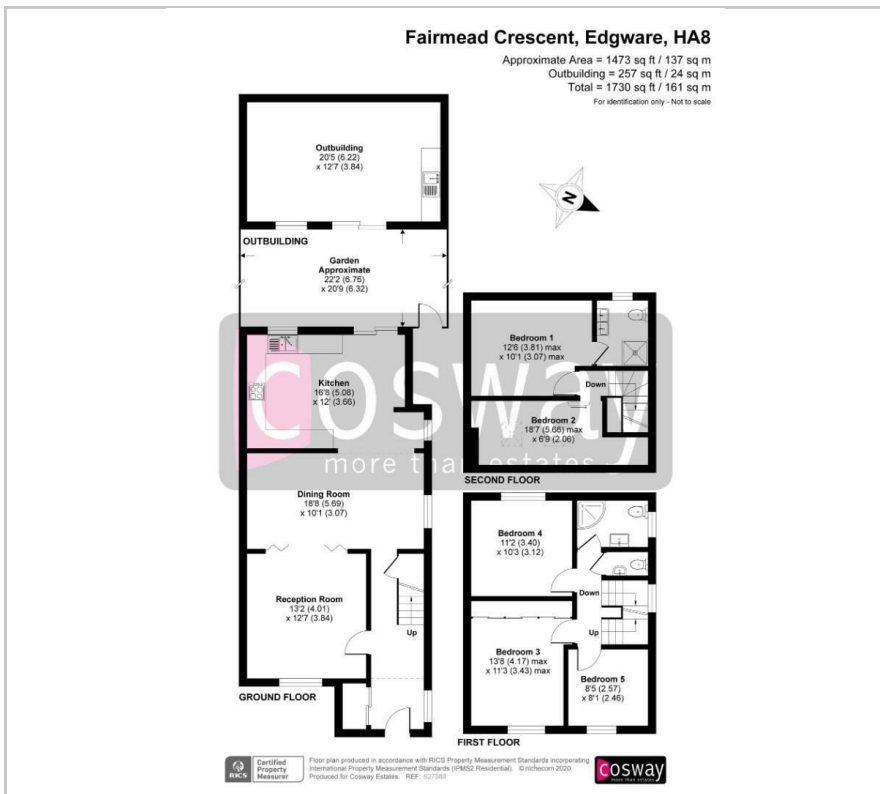

Area Map



Energy Efficiency Graph



These particulars, whilst believed to be accurate are set out as a general outline only for guidance and do not constitute any part of an offer or contract. Intending purchasers should not rely on them as statements of representation of fact, but must satisfy themselves by inspection or otherwise as to their accuracy. No person in this firm's employment has the authority to make or give any representation or warranty in respect of the property.